



**Alumil**  
Building excellence every day

**Alumil**  **SMARTIA**  
**M630 PHOS**



# CONTENTS

## SMARTIA M630 PHOS

DESIGN PHILOSOPHY & CHARACTERISTICS	4
SENSE OF FREEDOM	8
ATTENTION TO DETAIL	10
EXPLOITING EVERY CONTEMPORARY NEED	14
SECTIONS	18
INSTALLATION	30
APPLICATIONS	34
PERFORMANCE	35

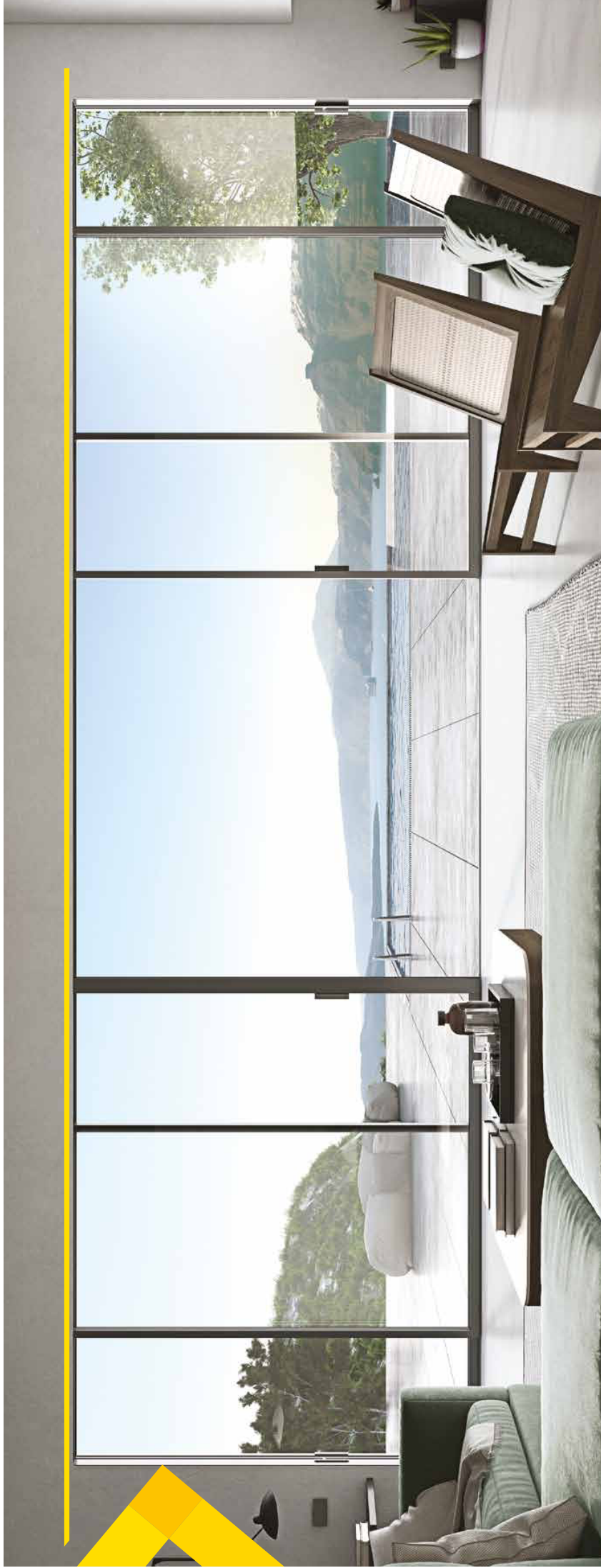

**SMARTIA M630 PHOS** is the ideal choice for minimal thermally insulated sliding windows and doors with wide glazing surfaces. The system can be installed either on-floor or flush to the floor offering a unique combination of elegance and functionality, satisfying even the most demanding requirements.

**PHOS** means **LIGHT**

*"I sense Light as the giver of all presences, and material as spent Light.  
What is made by Light casts a shadow, and the shadow belongs to Light."*

Not just a window  
a point of view.

LOUIS KAHN

The sliding system  
**SMARTIA M630 PHOS**  
 offers a minimal touch...

in contemporary residences combining  
 minimal design with **high thermal**  
**performance.**



Following the  
**“less is more”** philosophy,  
 all aluminium profiles can  
 be hidden into the walls  
 providing a total sense of  
 comfort with top functionality  
 and enhanced safety.

- Design ideal for “green” buildings, emphasizing on energy & money savings through thermally efficient solutions.
- Maximum natural light with only 44 mm of visible aluminium face width at the interlocking profile.
- Smart locking mechanism (international patent) with multiple locking points.
- Easy access thanks to the low threshold ideal for children, elders and people with special needs.
- Smooth sliding & maximum functionality with high resistance to corrosion with stainless steel rollers.
- Vast range of typologies available.

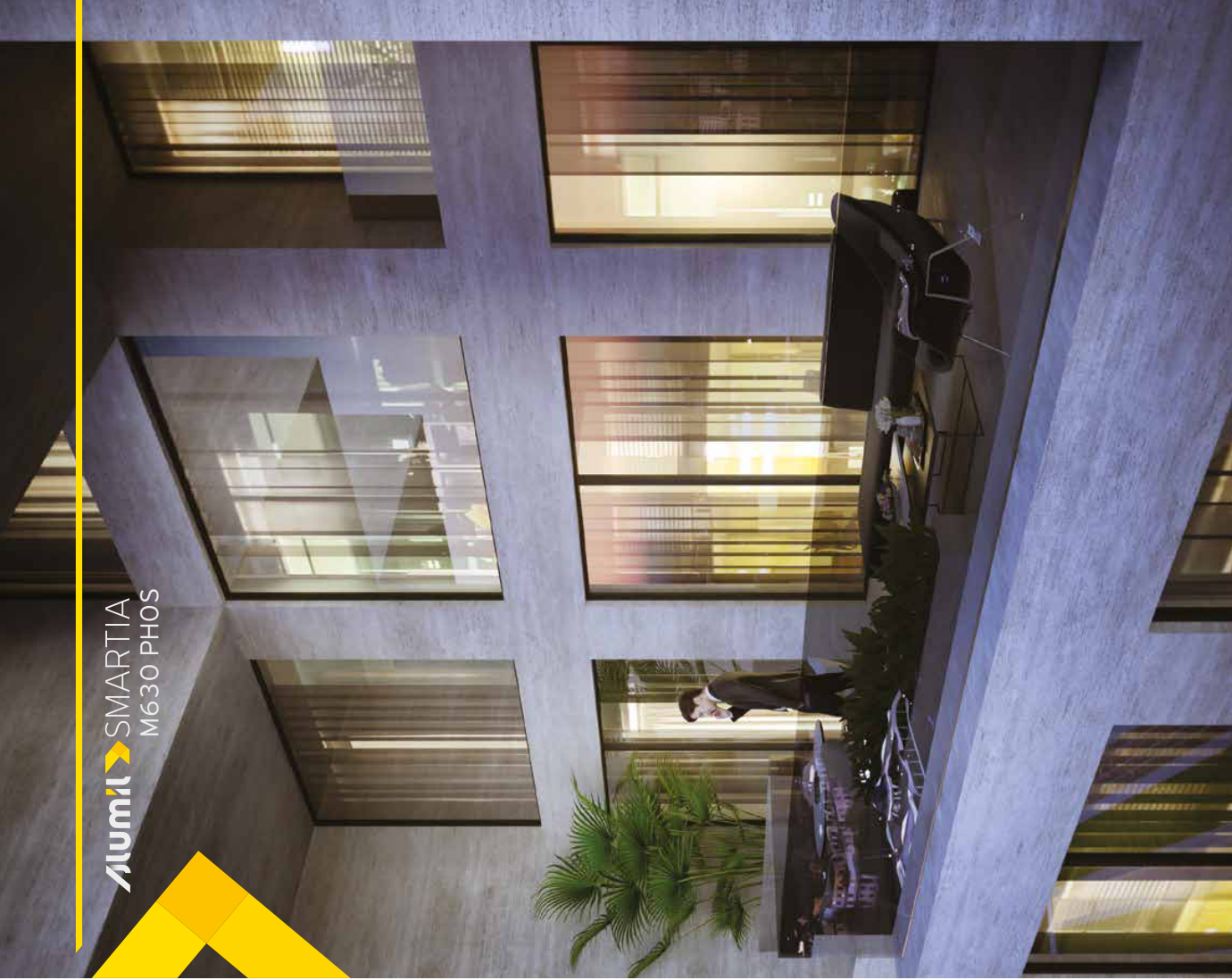

## TECHNICAL

## CHARACTERISTICS

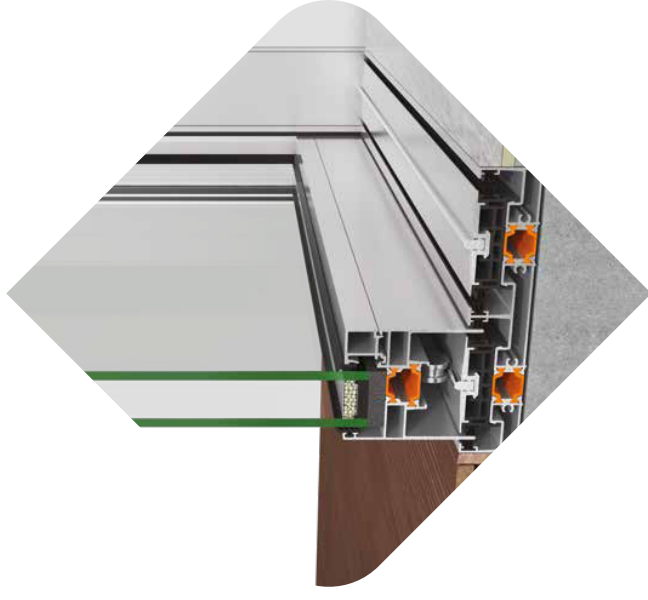

### VISIBLE ALUMINIUM FACE WIDTH

	CONCEALED PROFILES
FRAME HEIGHT	32 mm
FRAME WIDTH	155 mm
SASH WIDTH	63 mm
INTERLOCKING PROFILE WIDTH	44 mm
SASH WEIGH	UP TO 250 kg
GLAZING	32 mm
INSULATION	POLYAMIDES, PVC

The system's main characteristic is the aluminium frames that are **totally flush to the wall.**

Thus, it offers to the users **the sense of freedom** and direct interaction with the external environment.

Elegant coziness full of natural light thanks to the system's **minimal design and the wide glazing surfaces that can be integrated.** The visibility is enhanced with the slim interlocking profile of only

**44 mm** visible aluminium face width.





**ATTENTION**

**TO DETAIL**

Flat threshold with a height of only 32mm, which was specially designed for easy and safe access to children, the elderly and people with special needs.

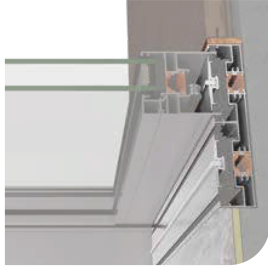

Stainless steel rollers ideal for seaside projects offering high functionality & smooth gliding of the sashes.

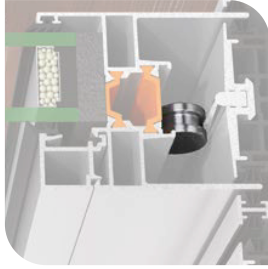

The door sash glides easily and quietly on the solid rail made by stainless steel AISI 316L.



SMARTIA M630 PHOS uses fiber-glass reinforced polyamides with 24mm & 20mm width, along with the contribute to the system's high energy efficiency.

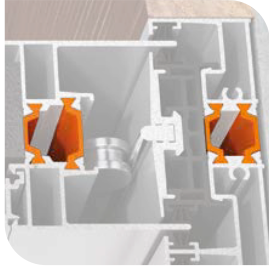

The unique PVC profiles contribute to the system's thermal insulation and watertightness.

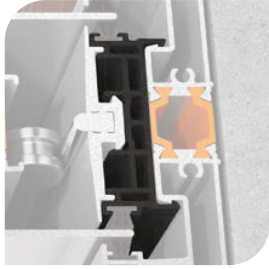

SMARTIA M630 PHOS uses high quality brushes with triple membrane contributing significantly to the system's air permeability and watertightness.

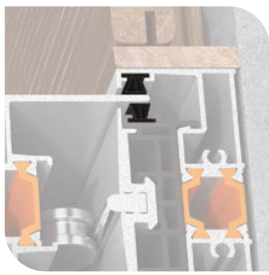

ATTENTION

TO DETAIL

Smart locking system  
(international patented)  
with ALUMIL design handle...

offer high security with multiple locking points.  
In addition, they are very easy to install after transportation  
on site and can be easily removed for maintenance.



The innovative design of the concealed water drainage system offers excellent performance even under adverse weather conditions. Specially perforated profiles and accessories, assembled together, facilitate the water outflow.

Even when the low threshold is selected for top-mounted installation, there is a special component for the concealed water drainage that offers high watertightness.

LOW THRESHOLD

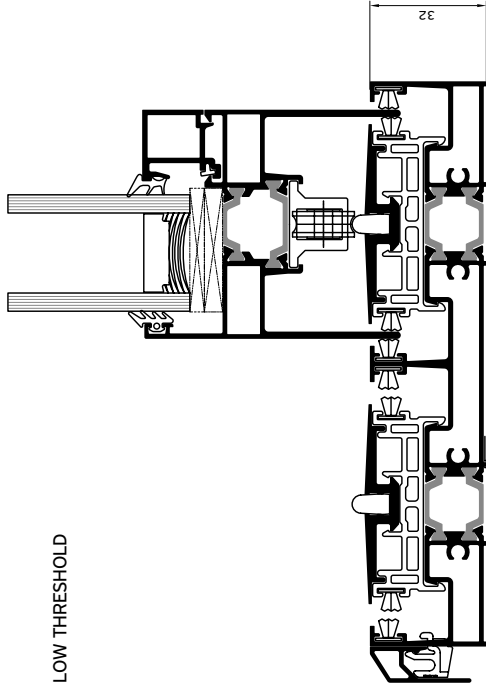

THRESHOLD WITH SUBSILL

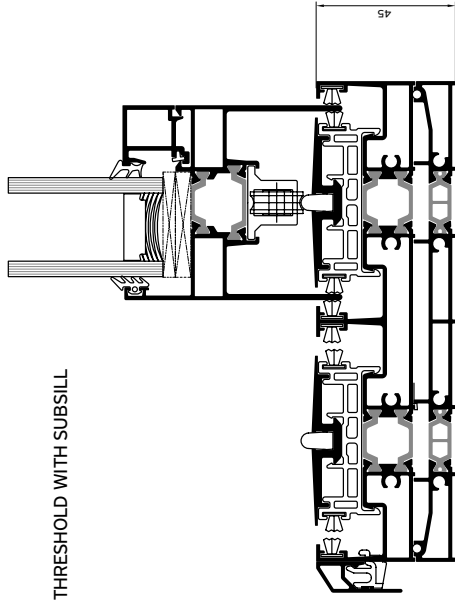

THRESHOLD WITH SUBSILL & GUTTER

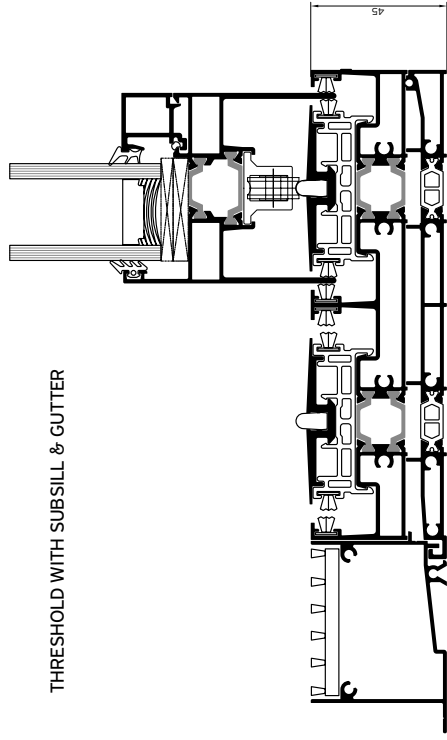

THRESHOLD WITH SUBSILL

In addition, the reinforced interlocking profile apart from aesthetics and functionality, offers robustness to the structure and resistance to wind loads for higher sashes.

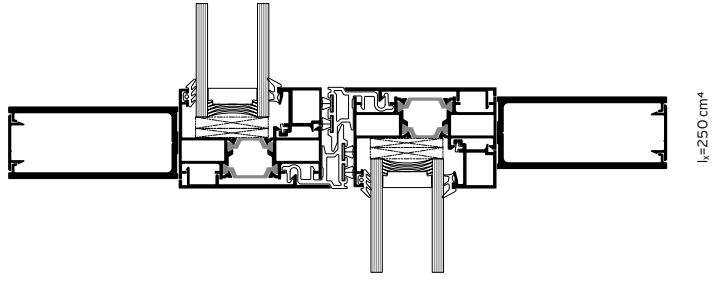
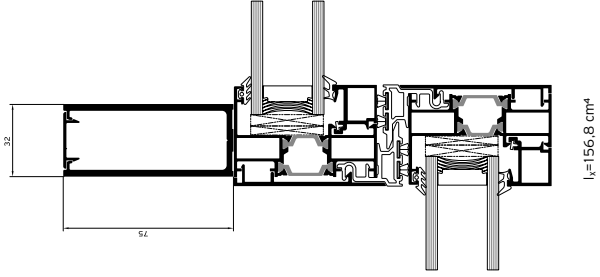
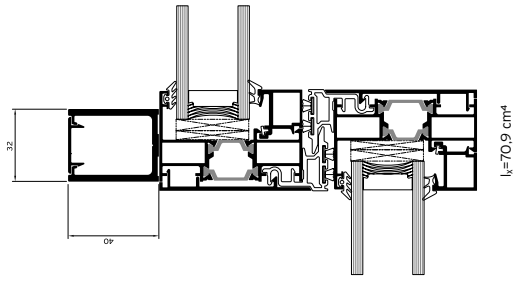
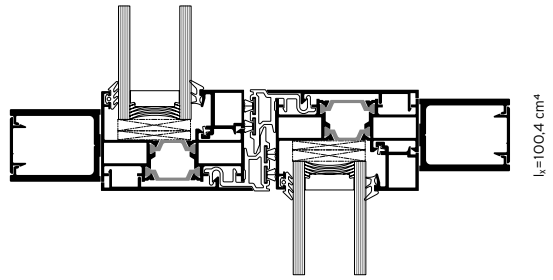
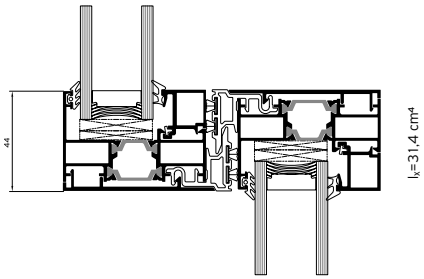

**2 Sashes / 2 Track**

**1 Sash / Fixed light**

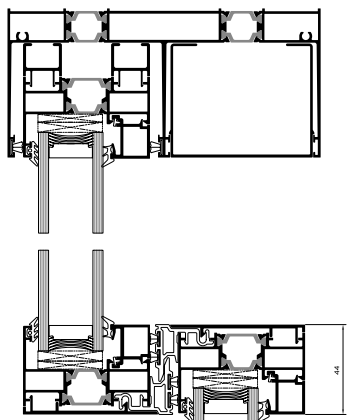
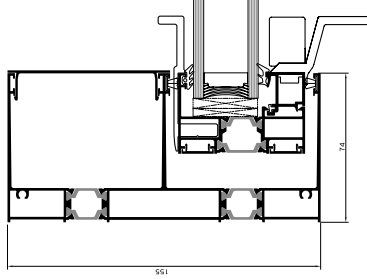
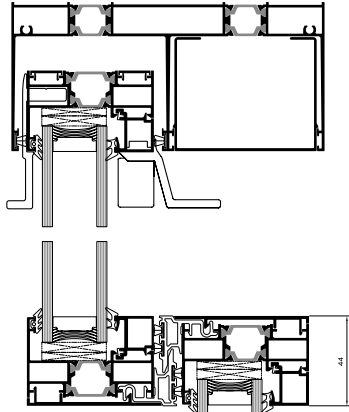
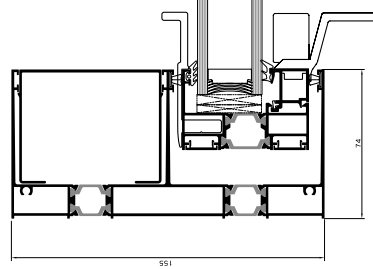
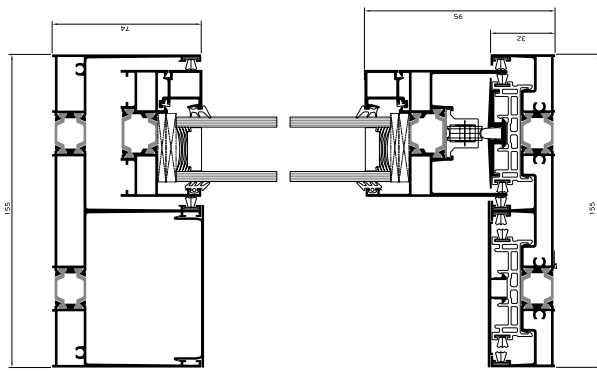
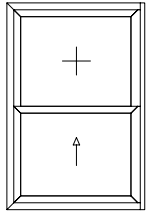
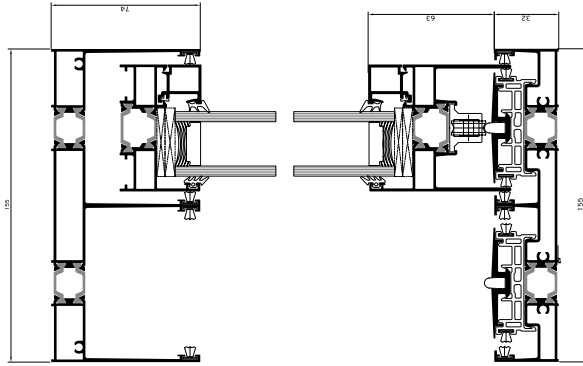
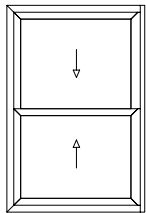

**3 Sashes / 3 Track**

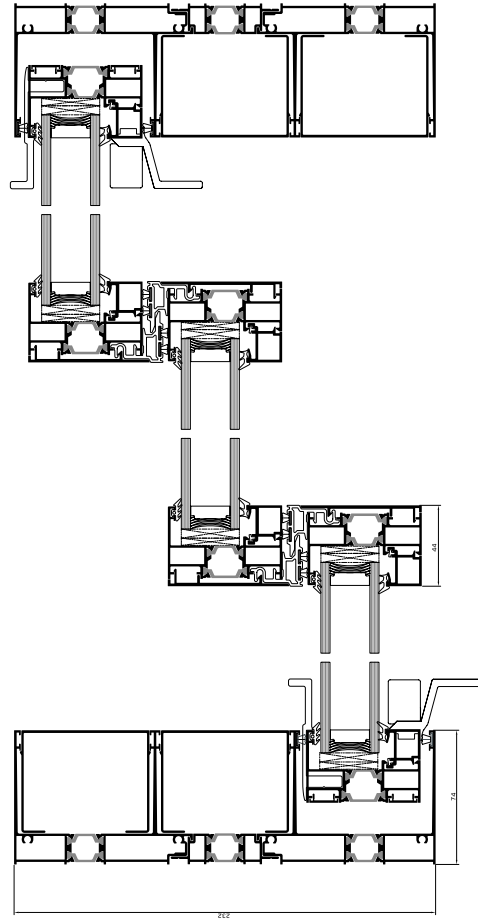
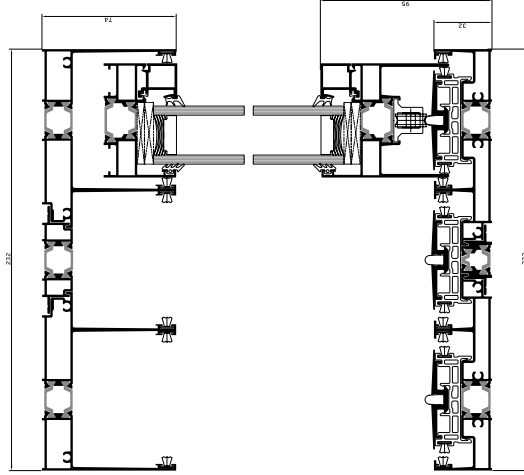
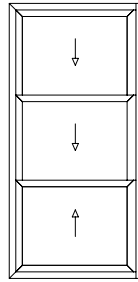

**2 Sashes / 2 Fixed lights / 2 Track**

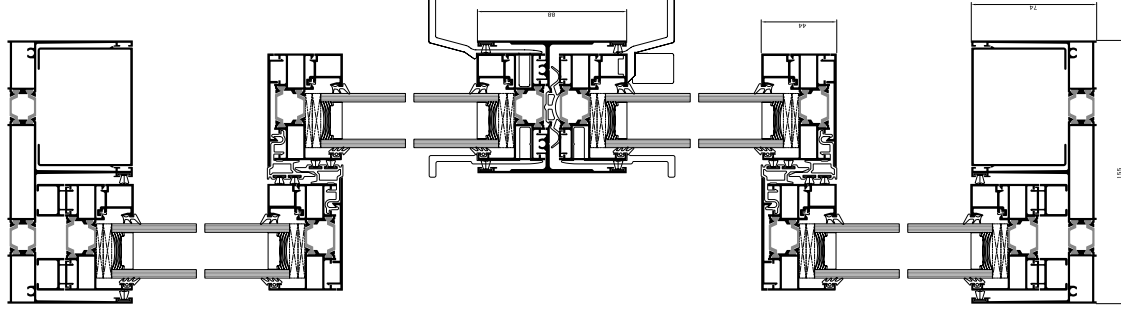
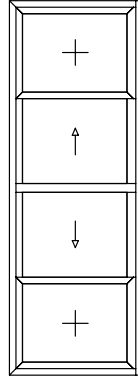

Rotate the technical drawing  
90° CLOCKWISE IN ORDER  
TO READ IT PROPERLY

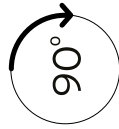



**POCKET WINDOW**  
1 Sash

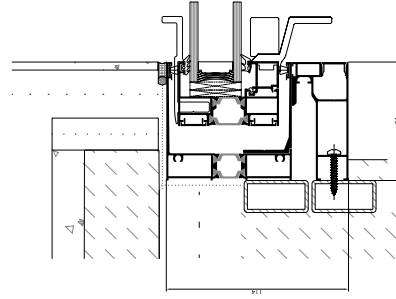
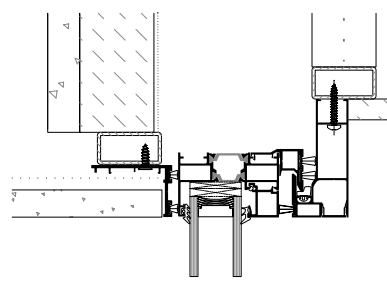
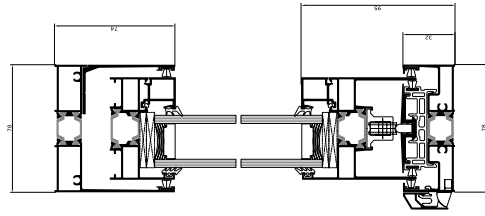
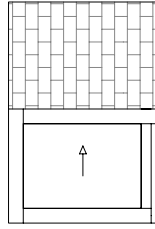





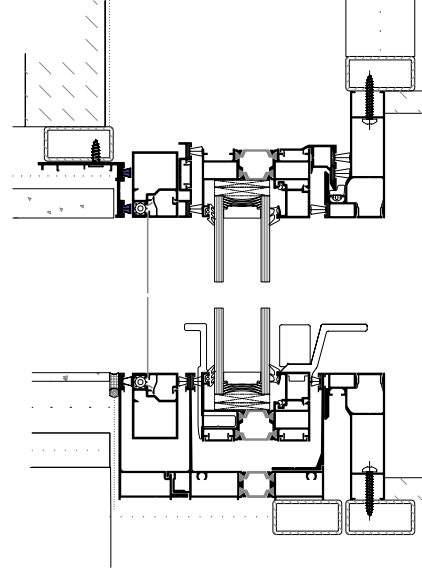
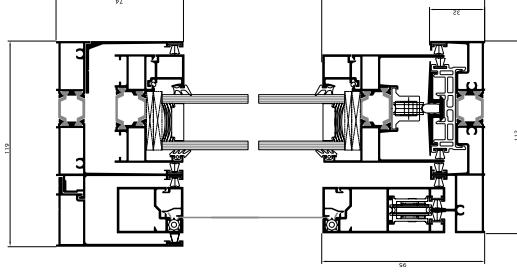
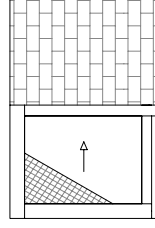

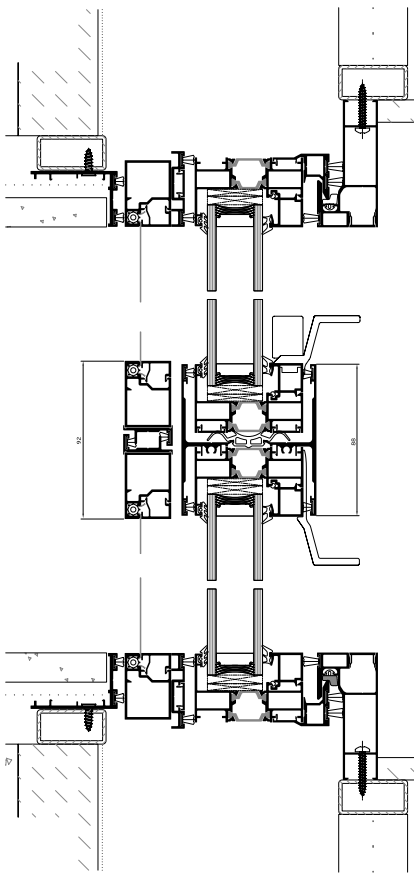
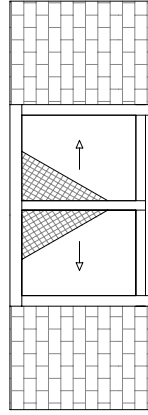
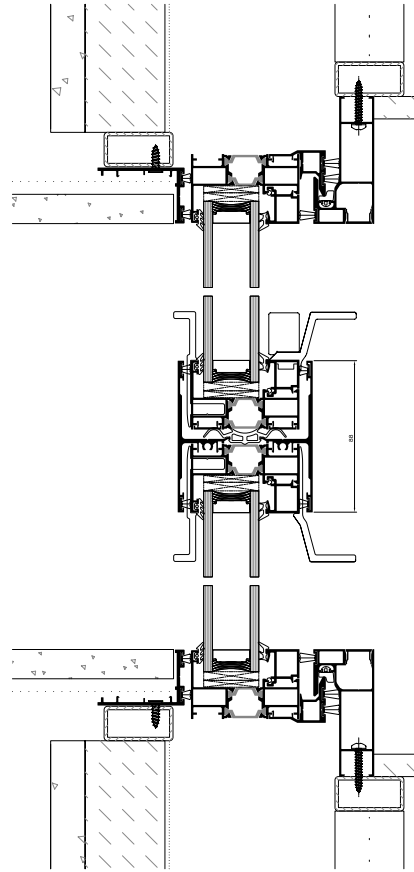
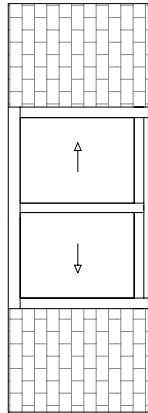

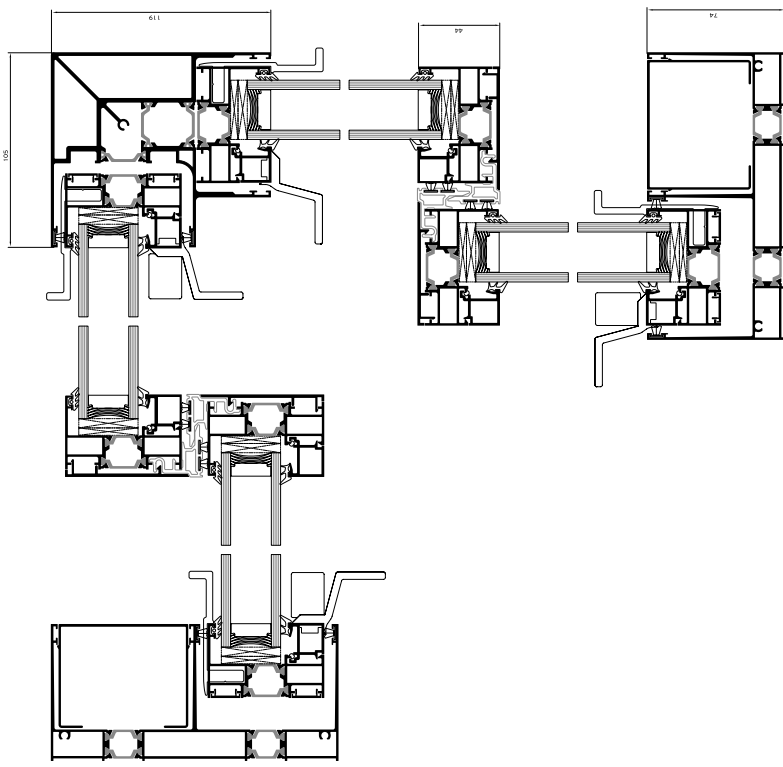
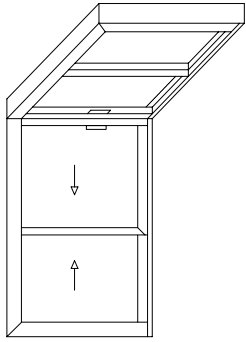
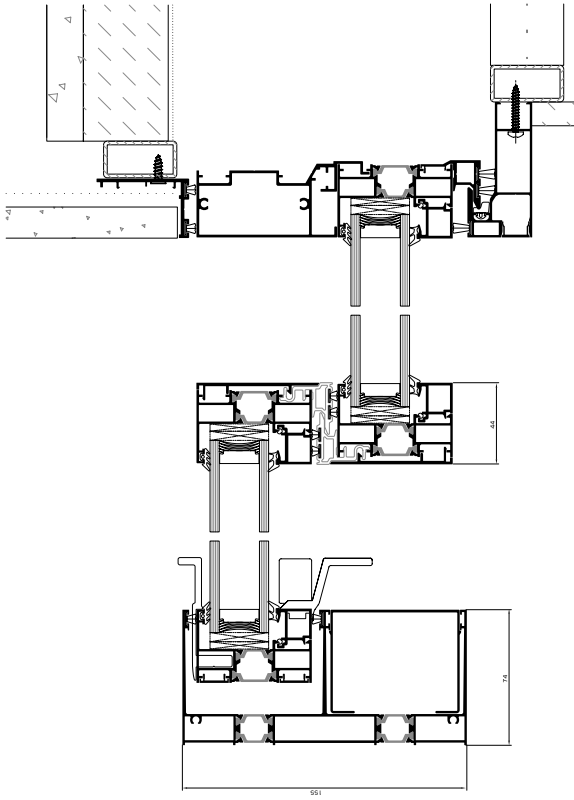
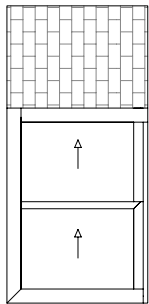



**POCKET WINDOW**

1 Sash / Flyscreen







	PRECOMPRESSED MULTI-FUNCTION SEALING TAPE
	BACKER ROD
	HYBRID SEALANT OR NEUTRAL SILICONE
	STYRODUR HIGH DENSITY BOARD
	TILES
	MARBLE
	POLYURETHANE FOAM
	POLYSTYRENE
	WALL CONSTRUCTION
	WALL FINISH
	REINFORCED CONCRETE
	AIR WATER VAPOR BARRIER TAPE

SIDE SECTION

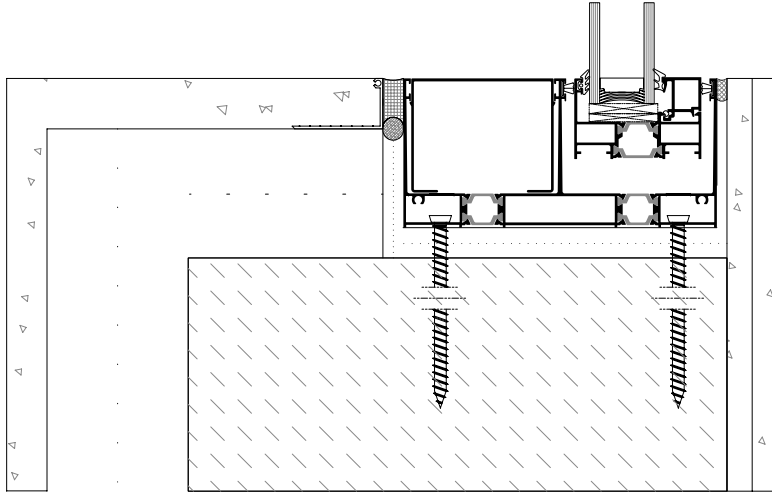

TOP SECTION

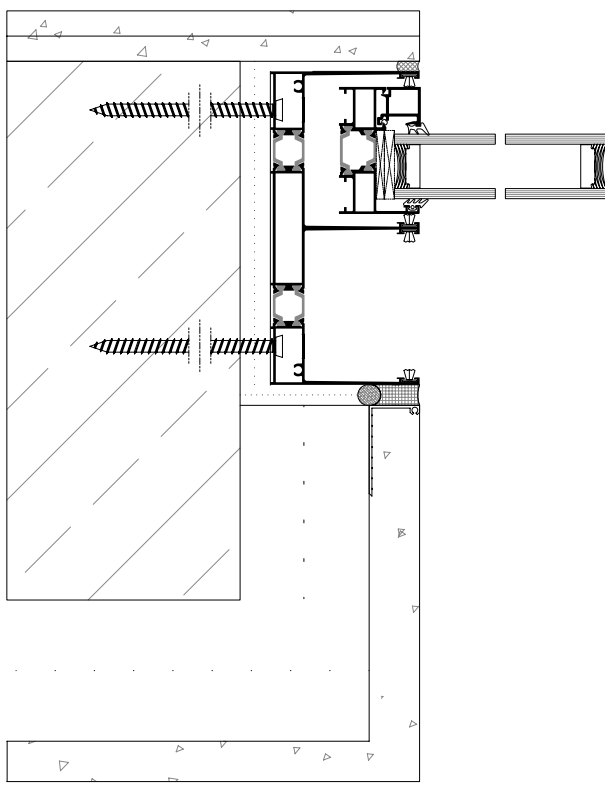

BOTTOM SECTION WITH GUTTER

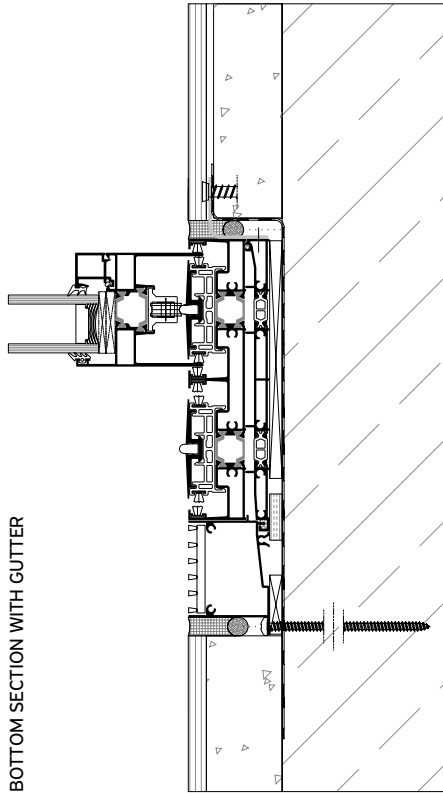

BOTTOM SECTION

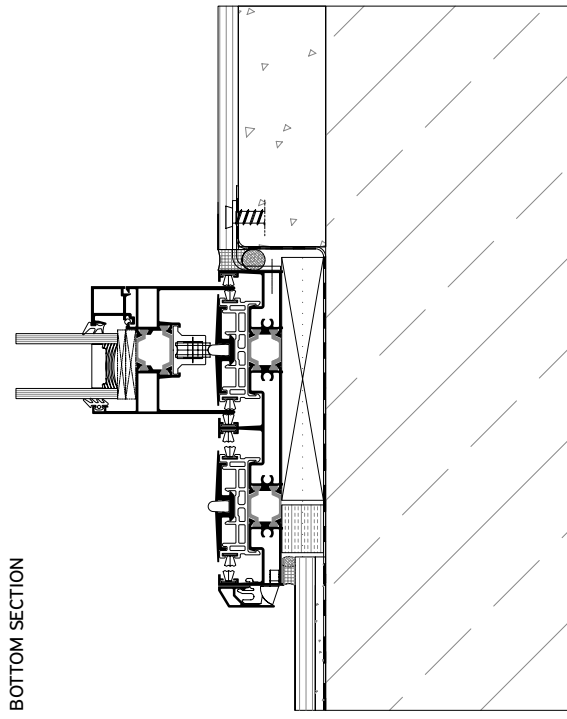

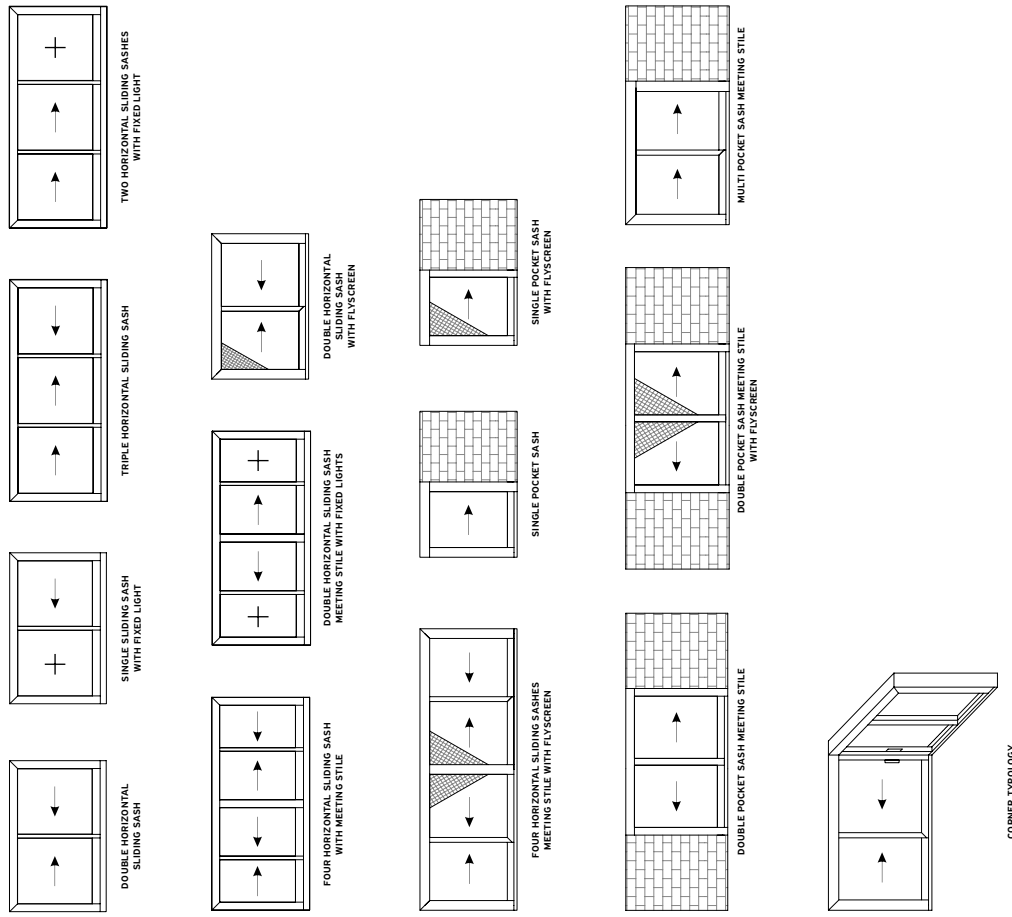

# Table of performance

CERTIFICATION	CLASSIFICATION								
	1A (0 Pa)	2A (50 Pa)	3A (100 Pa)	4A (150 Pa)	5A (200 Pa)	6A (250 Pa)	7A (300 Pa)	8A (450 Pa)	9A (600 Pa)
WATER TIGHTNESS EN 12208	1	2	3	4	5	6	7	8	9
AIR PERMEABILITY EN 12207	1	2	3	4	5	6	7	8	9
WIND LOAD RESISTANCE MAX TEST PRESSURE EN 12210	1 (400 Pa)	2 (800 Pa)	3 (1200 Pa)	4 (1600 Pa)	5 (2000 Pa)	6	7	8	9
WIND LOAD RESISTANCE TO FRONTAL DEFLECTION EN 12210	A (≤ 1/150)	B (≤ 1/200)	C (≤ 1/300)	D (≤ 1/400)	E (≤ 1/500)	F (≤ 1/600)	G (≤ 1/700)	H (≤ 1/800)	I (≤ 1/900)
SOUND REDUCTION EN ISO 140-3	Rw (C,Ctr) = 42 dB depending from the glazing type								
<b>THERMAL PERFORMANCE</b>	<b>DIMENSIONS IN MM</b> (w x h)		<b>U<sub>w</sub> in W/m<sup>2</sup>K</b> (U <sub>g</sub> = 0,6)		<b>U<sub>w</sub> in W/m<sup>2</sup>K</b> (U <sub>g</sub> = 0,8)		<b>U<sub>w</sub> in W/m<sup>2</sup>K</b> (U <sub>g</sub> = 1,1)		
2 SASHES / 2 TRACK	2300 x 2180	1,12	1,30	1,32	1,30	1,55			
3 SASHES / 3 TRACK	2450 x 2180	1,14	1,32	1,30	1,58				
4 SASHES / 2 TRACK	4600 x 2180	1,12	1,30	1,30	1,55				

[www.alumil.com](http://www.alumil.com)

**ALUMIL  
HEAD OFFICES  
& SHOWROOM - THESSALONIKI**

Cogoussi 8, Efkarpia  
Thessaloniki - GR 56429  
TEL.: +30 2313011000  
FAX.: +30 231692473  
E-MAIL: [info@alumil.com](mailto:info@alumil.com)

**ALUMIL  
HEADQUARTERS**

Kilkis Industrial Area  
Kilkis - GR 61100  
TEL.: +30 23410 79300  
FAX.: +30 23410 71988  
E-MAIL: [info@alumil.com](mailto:info@alumil.com)



**ALUMIL  
HEAD OFFICES  
& SHOWROOM - THESSALONIKI**

GOGOUSI 8, EFKARPIA  
THESSALONIKI - GR 56429

TEL.: +30 2313 011000  
FAX.: +30 2310 692473  
EMAIL.: info@alumil.com

**ALUMIL  
HEADQUARTERS**

KILKIS INDUSTRIAL AREA  
KILKIS - GR 61100

TEL.: +30 23410 79300  
FAX.: +30 23410 71988  
EMAIL.: info@alumil.com

**[www.alumil.com](http://www.alumil.com)**



**Alumil**